

REVISION HISTORY				
REV.	DESCRIPTION	DATE	ECO	BY
A	2014 POLYMER DIG BOOK	01/13/14	NONE	THARKENRIDER
B	UPDATED BOM	3/26/2014	NONE	RCOLBOCH
C	UPDATED TAG DATA TO INCLUDE COPING LENGTHS.	2/3/2015	391702	JBOSSERDET

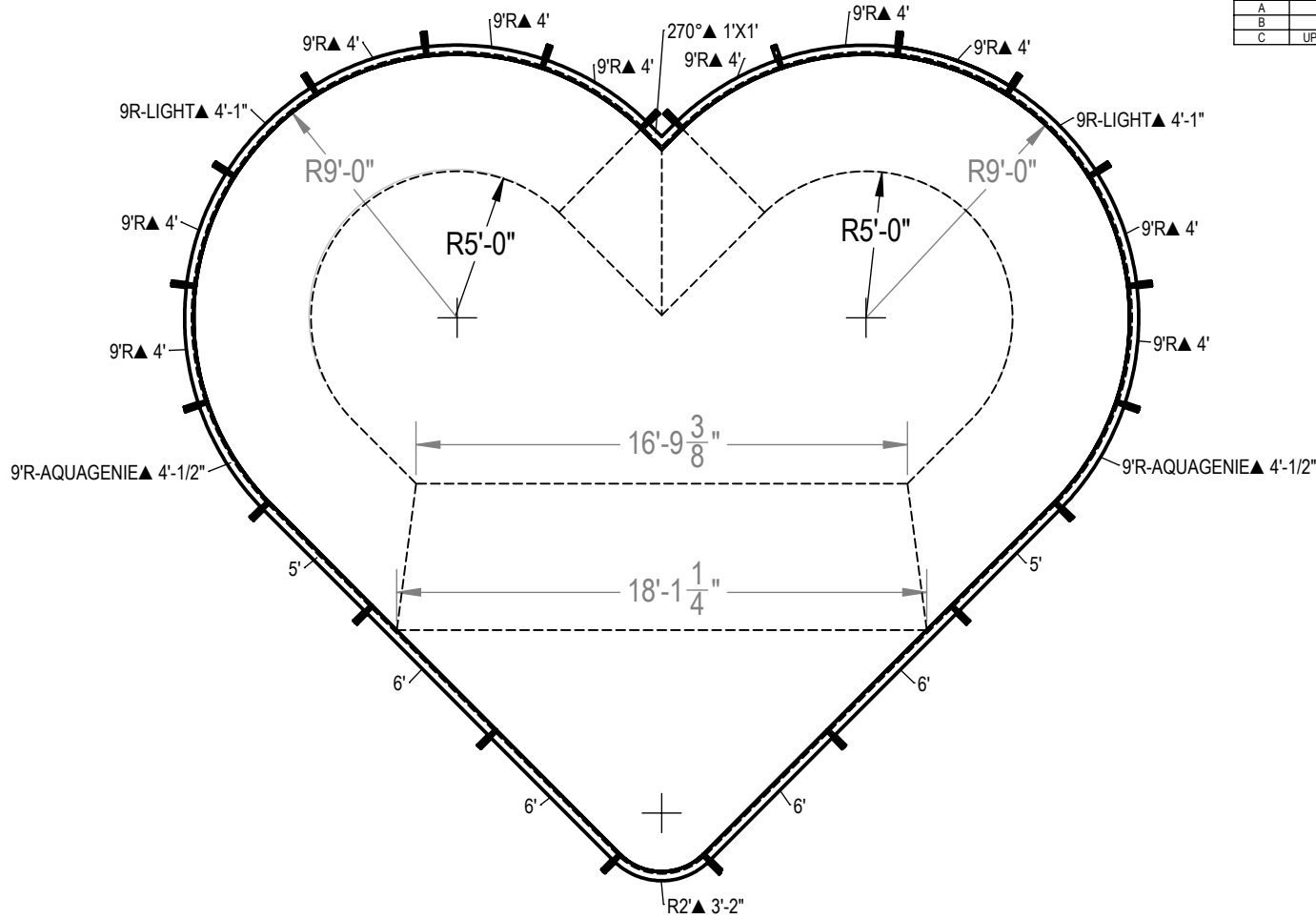

NOTES:

1. THESE ARE FINISHED DIMENSIONS READY FOR THE LINER.
2. DIMENSIONS ARE FROM INSIDE POOL PANELS.
3. ROPE AND FLOAT ASSEMBLY SHOULD BE INSTALLED IN ACCORDANCE WITH ANSI/APSP/ICC-5 2011 17.2.

EXCAVATION NOTES:

4. ROUGH EXCAVATION SHOULD BE 2" DEEPER IN EACH INSTANCE.
5. SOIL TO HAVE MINIMUM BEARING CAPACITY OF 1500 PSF.
6. LOCATE TOP OF POOL AT LEAST 6" ABOVE THE SURROUNDING LAND ELEVATION.
7. SEE "OVER DIG DETAIL" FOR EXCAVATION AROUND POOL.
8. FILL VOIDS UNDER BASE OF PANELS AND TAMP WELL.
9. BACK FILL WITH NON-EXPANSIVE MATERIAL.
10. ANSI / APSP / ICC-5 FOR RESIDENTIAL POOLS, 2003-2007 BOCA CODE SECTION 421.

IMPORTANT NOTES:

THIS DOCUMENT IS FOR ILLUSTRATIVE PURPOSES ONLY. THE DEALER OR CONTRACTOR WHO SELLS OR INSTALLS YOUR POOL IS AN INDEPENDENT CONTRACTOR AND IS NOT AN AGENT OF THE MANUFACTURER. THE CONSTRUCTION METHODS ILLUSTRATED HERE ARE SUGGESTIONS AND APPLY ONLY TO NORMAL GROUND CONDITIONS. THERE MAY BE ADDITIONAL PRECAUTIONS AND/OR METHODS OF CONSTRUCTION. PROPER INSTALLATION IS THE RESPONSIBILITY OF THE DEALER/BUILDER/CONTRACTOR.

ITEM	FILE NAME	DESCRIPTION	CUSTOMER DRAWING #	VENDOR PART #	QTY.	VENDOR NAME	MATERIAL
1	BRACE	BRACE, 4 TAB, HYDRA - 100 SERIES	HP199	HP199	21	HYDRA POOLS	PS
2	PANEL, 2' RADIUS	PANEL, 2' RADIUS - 100 SERIES	HP152M	HP152M	1	HYDRA POOLS	PS
3	PANEL, 5' LONG	PANEL, 5' LONG - 100 SERIES	HP105	HP105	2	HYDRA POOLS	PS
4	PANEL, 6' LONG	PANEL, 6' LONG - 100 SERIES	HP106	HP106	4	HYDRA POOLS	PS
5	PANEL, 9' RADIUS WITH AQUAGENIE	PANEL, 9' RADIUS WITH AQUAGENIE - 100 SERIES	HP159A	HP159A	2	HYDRA POOLS	PS
6	PANEL, 9' RADIUS WITH LIGHT	PANEL, 9' RADIUS WITH LIGHT - 100 SERIES	HP159LL	HP159LL	2	HYDRA POOLS	PS
7	PANEL, 9' RADIUS, 4' LONG	PANEL, 9' RADIUS, 4' LONG - 100 SERIES	HP159	HP159	11	HYDRA POOLS	PS
8	PANEL, L, 270° X 1' X 1'	PANEL, L, 270° X 1' X 1' - 100 SERIES	HP122	HP122	1		PS

ENGINEERING DRAWING NUMBER: 00005096	WEIGHT:	UNLESS OTHERWISE SPECIFIED	DESIGNED BY:	CREATION DATE:	HYDRA POOLS	
	lbs		RCOLBOCH	10/29/2013		
	VOLUME:		DIMENSIONS ARE IN INCHES	DETAILED BY:		DETAILED DATE:
	Inch ³		TOLERANCES	JBOSSERDET		10/5/2012
COLOR:	DECIMALS: X ± .1	LAST REVISED BY:	LAST REVISED DATE:	TITLE:	LAYOUT, 32' X 28', HEART, 5' DEEP, 100 SERIES	
NA	XX ± .01	Jbosserdet	2/3/2015	PART NUMBER:		
HEAT TREAT:	XXX ± .001	MATERIAL:		SCALE:		
NA	XXXX ± .0005			1:192		
FINISH:	ANGULAR: X ± 0.5			SHEET:	10994	
NA	THIRD ANGLE PROJECTION			1 OF 4		
TEXTURE:				SIZE:	A	
NA						

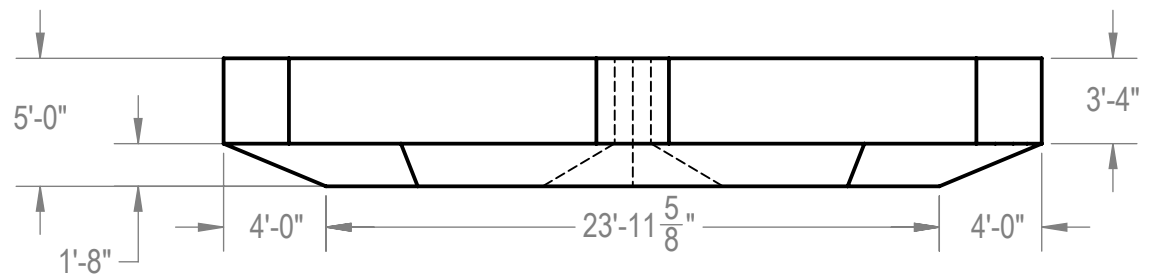
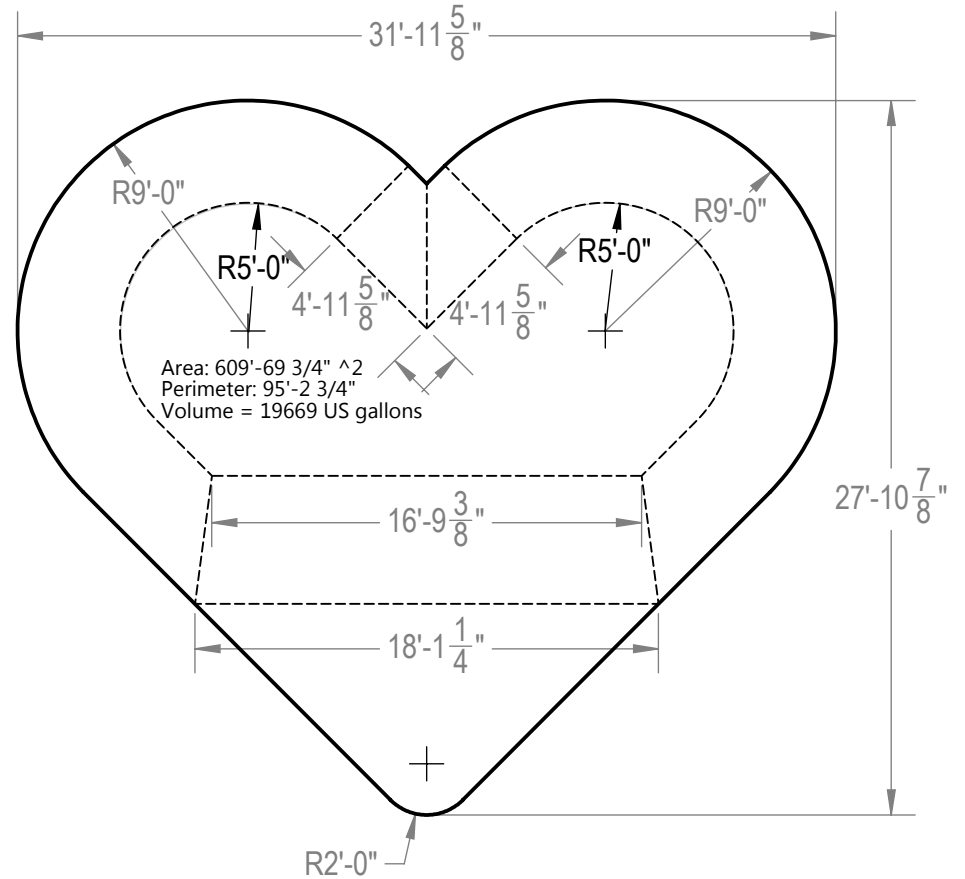
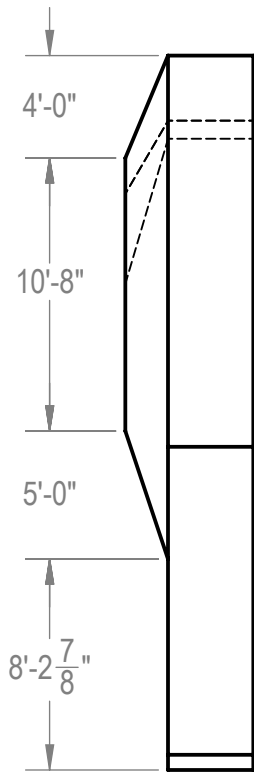

NOTES:

1. THESE ARE FINISHED DIMENSIONS READY FOR THE LINER.
2. DIMENSIONS ARE FROM INSIDE POOL PANELS.
3. ROPE AND FLOAT ASSEMBLY SHOULD BE INSTALLED IN ACCORDANCE WITH ANSI/ASPS/ICC-5 2011 17.2.

EXCAVATION NOTES:

4. ROUGH EXCAVATION SHOULD BE 2" DEEPER IN EACH INSTANCE.
5. SOIL TO HAVE MINIMUM BEARING CAPACITY OF 1500 PSF.
6. LOCATE TOP OF POOL AT LEAST 6" ABOVE THE SURROUNDING LAND ELEVATION.
7. SEE "OVER DIG DETAIL" FOR EXCAVATION AROUND POOL.
8. FILL VOIDS UNDER BASE OF PANELS AND TAMP WELL.
9. BACK FILL WITH NON-EXPANSIVE MATERIAL.
10. ANSI / APSP / ICC-5 FOR RESIDENTIAL POOLS, 2003-2007 BOCA CODE SECTION 421.

IMPORTANT NOTES:

THIS DOCUMENT IS FOR ILLUSTRATIVE PURPOSES ONLY. THE DEALER OR CONTRACTOR WHO SELLS OR INSTALLS YOUR POOL IS AN INDEPENDENT CONTRACTOR AND IS NOT AN AGENT OF THE MANUFACTURER. THE CONSTRUCTION METHODS ILLUSTRATED HERE ARE SUGGESTIONS AND APPLY ONLY TO NORMAL GROUND CONDITIONS. THERE MAY BE ADDITIONAL PRECAUTIONS AND/OR METHODS OF CONSTRUCTION. PROPER INSTALLATION IS THE RESPONSIBILITY OF THE DEALER/BUILDER/CONTRACTOR.

ENGINEERING DRAWING NUMBER: 00005096	WEIGHT:	UNLESS OTHERWISE SPECIFIED DIMENSIONS ARE IN INCHES TOLERANCES DECIMALS: X ± .1 XX ± .01 XXX ± .001 XXXX ± .0005 ANGULAR: X ± 0.5 THIRD ANGLE PROJECTION	DESIGNED BY:	CREATION DATE:	HYDRA POOLS
	lbs		RCOLBOCH	10/28/2013	
	VOLUME:			DETAILED BY:	DETAILED DATE:
	Inch ³			JBOSSERDET	10/5/2012
COLOR:		LAST REVISED BY:	LAST REVISED DATE:	TITLE:	LAYOUT, 32' X 28', HEART, 5' DEEP, 100 SERIES
HEAT TREAT:		jbosserdet	2/3/2015	PART NUMBER:	10994
NA		MATERIAL:		SCALE:	1:192
FINISH:				SHEET:	2 OF 4
NA				SIZE:	A
TEXTURE:					
NA					

A-S1	24'-9"
B-S1	36'- 5/8"
A-S2	36'- 5/8"
B-S2	24'-9"
A-S3	20'-7 1/8"
B-S3	32'-7"
A-S4	32'-7"
B-S4	20'-7 1/8"

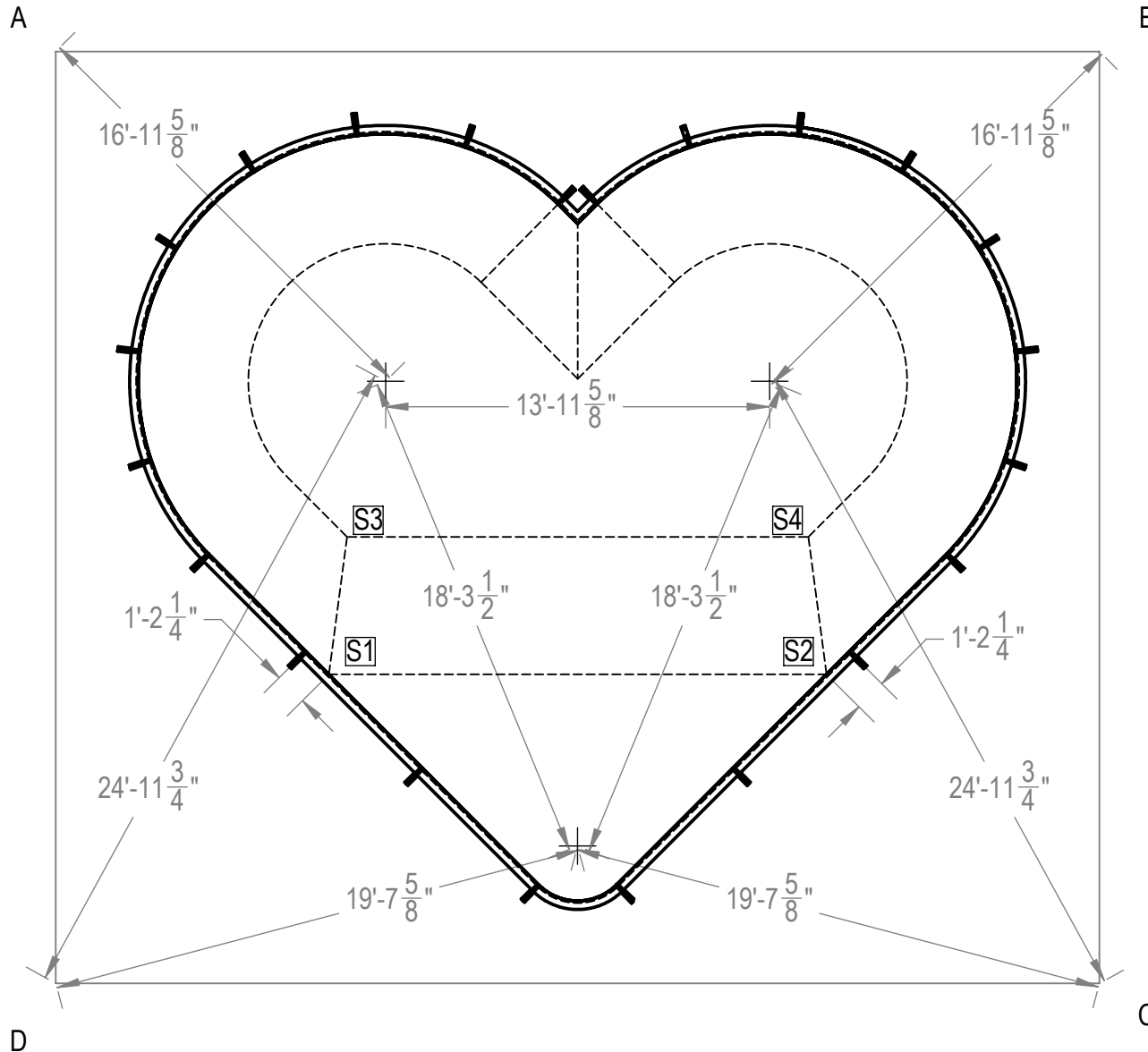

ENGINEERING DRAWING NUMBER: 00005096	WEIGHT:	UNLESS OTHERWISE SPECIFIED DIMENSIONS ARE IN INCHES TOLERANCES DECIMALS: X ± .1 XX ± .01 XXX ± .001 XXXX ± .0005 ANGULAR: X ± 0.5 THIRD ANGLE PROJECTION	DESIGNED BY:	CREATION DATE:	HYDRA POOLS LAYOUT, 32' X 28', HEART, 5' DEEP, 100 SERIES
	lbs		RCOLBOCH	10/29/2013	
	VOLUME:		DETAILED BY:	DETAILED DATE:	
	Inch ³		JBOSSERDET	10/5/2012	
COLOR:	LAST REVISED BY:	LAST REVISED DATE:	TITLE:		
NA	jbossedet	2/3/2015			
HEAT TREAT:	MATERIAL:				
NA					
FINISH:					
NA					
TEXTURE:					
NA					
			PART NUMBER:	SCALE:	SIZE:
			10994	1:192	A
				SHEET:	
				3 OF 4	

	A	B	C	D
1	20'-5 1/2"	19'-1 1/4"	33'-8 7/8"	34'-6 1/4"
2	23'-4 1/8"	15'-3 1/2"	33'-10 3/8"	38'-2 1/4"
3	27'-2 3/8"	11'-4 3/8"	32'-8 3/4"	41'- 1/8"
4	31'- 7/8"	8'-5 1/4"	30'-4 5/8"	42'-7 5/8"
5	34'-4"	8'-5 1/8"	27'-1"	42'-10 7/8"
6	36'-6 7/8"	11'-4 1/8"	23'-2 1/4"	41'-9 1/2"
7	37'-6 3/4"	15'-3 1/4"	19'-4 1/4"	39'-4 3/4"
8	37'-2 1/2"	19'-1 3/8"	16'-7"	35'-11 5/8"
9	36'-2 3/8"	23'-7 3/4"	15'-1 3/8"	31'-3 1/2"
10	35'-10 1/2"	29'-3 3/8"	15'-5 1/2"	25'-11 7/8"
11	36'-6 1/2"	35'- 1/2"	17'-11 1/8"	20'-8 1/2"
12	35'- 1/2"	36'-6 1/2"	20'-8 1/2"	17'-11 1/8"
13	29'-3 3/8"	35'-10 1/2"	25'-10 1/4"	15'-5 1/2"
14	23'-7 3/4"	36'-2 3/8"	31'-3 5/8"	15'-1 1/2"
15	19'-1 3/8"	37'-2 1/2"	35'-11 3/4"	16'-7"
16	15'-3 1/4"	37'-6 3/4"	39'-4 7/8"	19'-4 1/4"
17	11'-4 1/8"	36'-6 7/8"	41'-9 1/2"	23'-2 1/4"
18	8'-5 1/8"	34'-4"	42'-10 7/8"	27'-1"
19	8'-5 1/4"	31'- 7/8"	42'-7 5/8"	30'-4 3/4"
20	11'-4 3/8"	27'-2 1/4"	41'- 1/8"	32'-8 3/4"
21	15'-3 1/2"	23'-4"	38'-2 1/4"	33'-10 1/2"
22	19'-1 1/4"	20'-5 1/2"	34'-6 1/4"	33'-8 7/8"

A-B	37'-11 5/8"
B-C	33'-10 7/8"
A-C	50'-10 7/8"

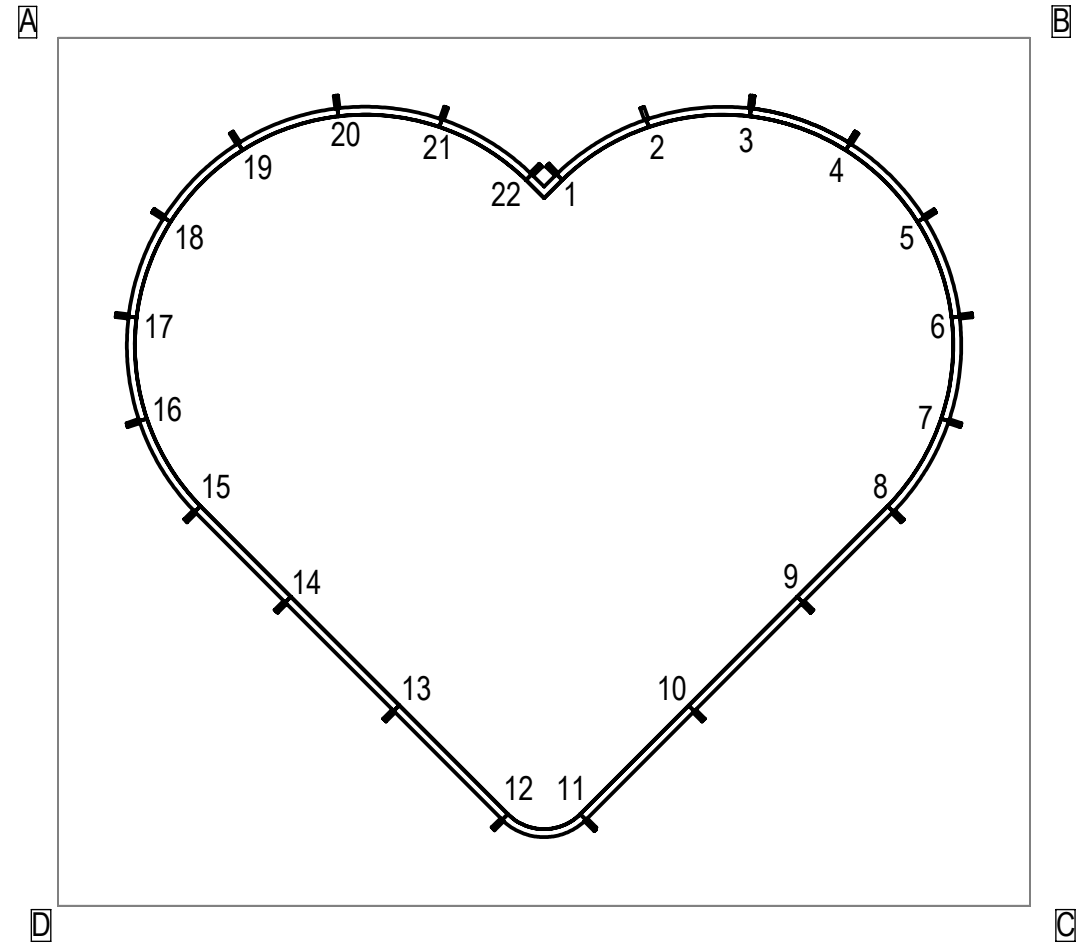

ENGINEERING DRAWING NUMBER: 00005096	WEIGHT:	UNLESS OTHERWISE SPECIFIED DIMENSIONS ARE IN INCHES TOLERANCES DECIMALS: X ± .1 XX ± .01 XXX ± .001 XXXX ± .0005 ANGULAR: X ± 0.5 THIRD ANGLE PROJECTION	DESIGNED BY:	CREATION DATE:	HYDRA POOLS
	lbs		RCOLBOCH	10/29/2013	
	VOLUME:		Detailed by:	Detailed Date:	LAYOUT, 32' X 28', HEART, 5' DEEP, 100 SERIES
	Inch ³		JBOSSERDET	10/5/2012	
COLOR:	LAST REVISED BY:	LAST REVISED DATE:	PART NUMBER:	SCALE:	SIZE:
NA	jbosserdet	2/3/2015	10994	1:192	A
HEAT TREAT:	MATERIAL:				
NA					
FINISH:					
NA					
TEXTURE:					
NA					