

REVISION HISTORY				
REV.	DESCRIPTION	DATE	ECO	BY
A	2014 POLYMER DIG BOOK	01/03/14	NONE	THARKENRIDER
B	UPDATED BOM	3/26/2014	NONE	RCOLBOCH
C	UPDATED TAG DATA TO INCLUDE COPING LENGTHS.	1/23/2015	391702	JBOSSERDET

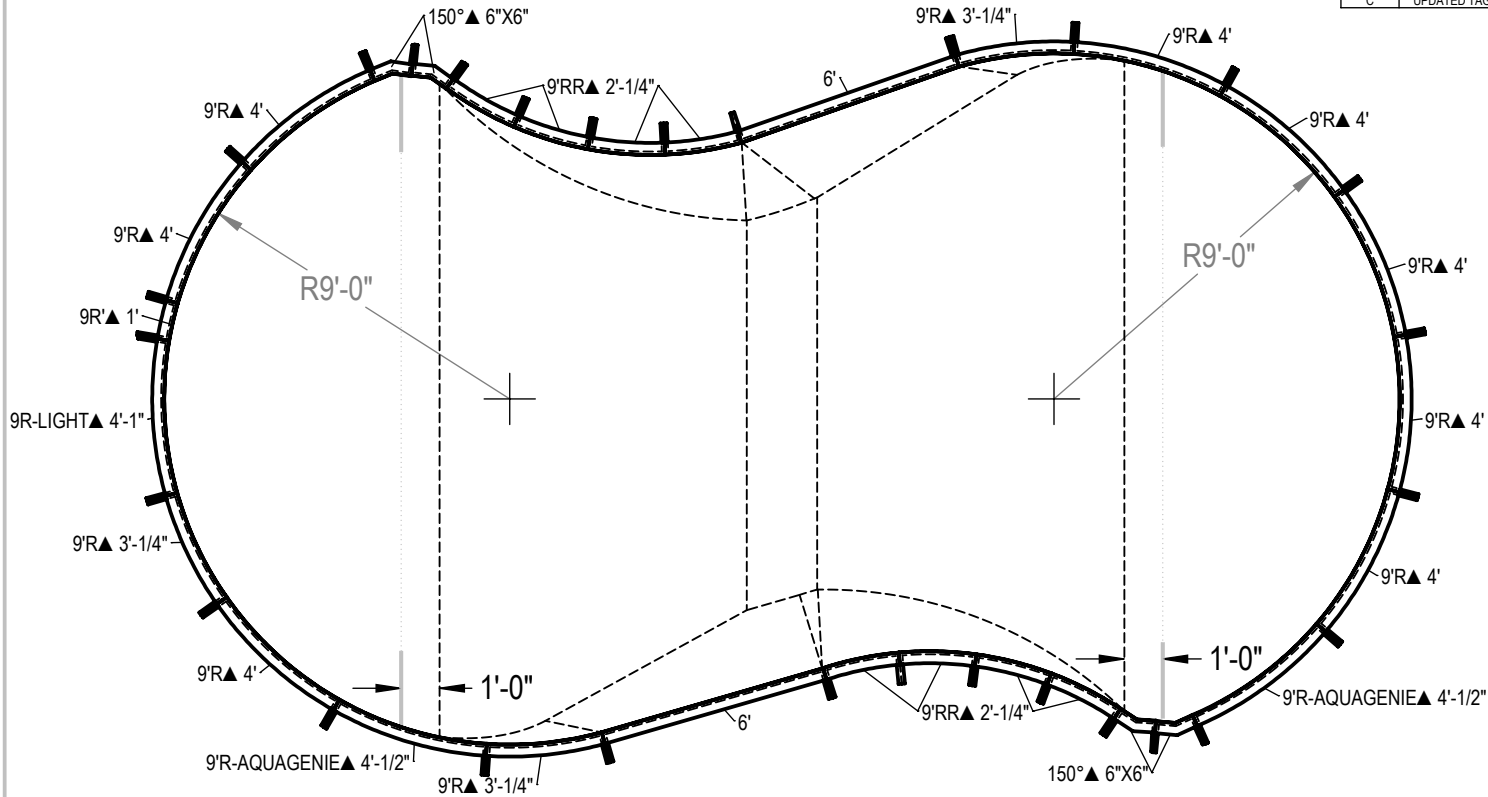

ITEM	FILE NAME	DESCRIPTION	CUSTOMER DRAWING #	VENDOR PART #	QTY.	VENDOR NAME	MATERIAL
1	BRACE	BRACE, 4 TAB, HYDRA - 100 SERIES	HP199	HP199	29	HYDRA POOLS	PS
2	PANEL, 6' LONG	PANEL, 6' LONG - 100 SERIES	HP106	HP106	2	HYDRA POOLS	PS
3	PANEL, 9' RADIUS WITH AQUA GENIE	PANEL, 9' RADIUS WITH AQUAGENIE - 100 SERIES	HP159A	HP159A	2	HYDRA POOLS	PS
4	PANEL, 9' RADIUS WITH LIGHT	PANEL, 9' RADIUS WITH LIGHT - 100 SERIES	HP159LL	HP159LL	1	HYDRA POOLS	PS
5	PANEL, 9' RADIUS, 1' LONG	PANEL, 9' RADIUS, 1' LONG - 100 SERIES	HP115	HP115	1	HYDRA POOLS	PS
6	PANEL, 9' RADIUS, 3' LONG	PANEL, 9' RADIUS, 3' LONG, ROMAN - 100 SERIES	HP125	HP125	3	HYDRA POOLS	PS
7	PANEL, 9' RADIUS, 4' LONG	PANEL, 9' RADIUS, 4' LONG - 100 SERIES	HP159	HP159	8	HYDRA POOLS	PS
8	PANEL, 9' REVERSE RADIUS	PANEL, 9' REVERSE RADIUS - 100 SERIES	HP119N	HP119N	8	HYDRA POOLS	PS
9	PANEL, L, 150° X 6' IN X 6' IN	PANEL, L, 150° X 6' X 6' - 100 SERIES	HP121	HP121	4	HYDRA POOLS	PS

**NOTES:**

- THESE ARE FINISHED DIMENSIONS READY FOR THE LINER.
- DIMENSIONS ARE FROM INSIDE POOL PANELS.
- THE IDEAL WATER LEVER SHOULD BE TO THE MIDDLE OF THE SKIMMER OPENING(S).

**EXCAVATION NOTES:**

- ROUGH EXCAVATION SHOULD BE 2" DEEPER IN EACH INSTANCE.
- SOIL TO HAVE MINIMUM BEARING CAPACITY OF 1500 PSF.
- LOCATE TOP OF POOL AT LEAST 6" ABOVE THE SURROUNDING LAND ELEVATION.
- SEE "OVER DIG DETAIL" FOR EXCAVATION AROUND POOL.
- FILL VOIDS UNDER BASE OF PANELS AND TAMP WELL.
- BACK FILL WITH NON-EXPANSIVE MATERIAL.
- ANSI / APSP / ICC-5 FOR RESIDENTIAL POOLS, 2003-2007 BOCA CODE SECTION 421.

**IMPORTANT NOTES:**

- THIS DOCUMENT IS FOR ILLUSTRATIVE PURPOSES ONLY. THE DEALER OR CONTRACTOR WHO SELLS OR INSTALLS YOUR POOL IS AN INDEPENDENT CONTRACTOR AND IS NOT AN AGENT OF THE MANUFACTURER. THE CONSTRUCTION METHODS ILLUSTRATED HERE ARE SUGGESTIONS AND APPLY ONLY TO NORMAL GROUND CONDITIONS. THERE MAY BE ADDITIONAL PRECAUTIONS AND/OR METHODS OF CONSTRUCTION. PROPER INSTALLATION IS THE RESPONSIBILITY OF THE DEALER/BUILDER/CONTRACTOR.

ENGINEERING DRAWING NUMBER: <b>00004999</b>	<b>UNLESS OTHERWISE SPECIFIED</b> DIMENSIONS ARE IN INCHES TOLERANCES DECIMALS: X ± .1 XX ± .01 XXX ± .001 XXXX ± .0005	DESIGNED BY: <b>RCOLBOCH</b> DETAILED BY: <b>JBOSSERDET</b> LAST REVISED BY: <b>jbosserdet</b> MATERIAL:	CREATION DATE: <b>10/30/2013</b> DETAILED DATE: <b>10/5/2012</b> LAST REVISED DATE: <b>1/23/2015</b>	<b>HYDRA POOLS</b> TITLE: <b>LAYOUT, 18' X 32'-2", BAHAMA, 6' DEEP, 100 SERIES</b> PART NUMBER: <b>10901</b>	SCALE: 1:128 SHEET: 1 OF 6 <b>A</b>
	WEIGHT: lbs VOLUME: Inch <sup>3</sup> COLOR: NA HEAT TREAT: NA FINISH: NA TEXTURE: NA	ANGULAR: X ± 0.5 THIRD ANGLE PROJECTION			

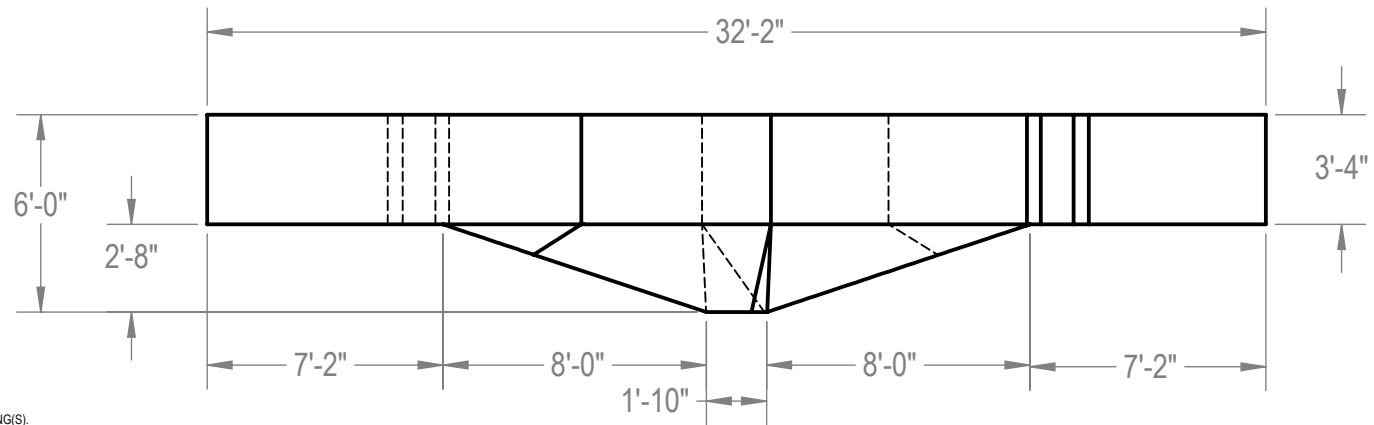
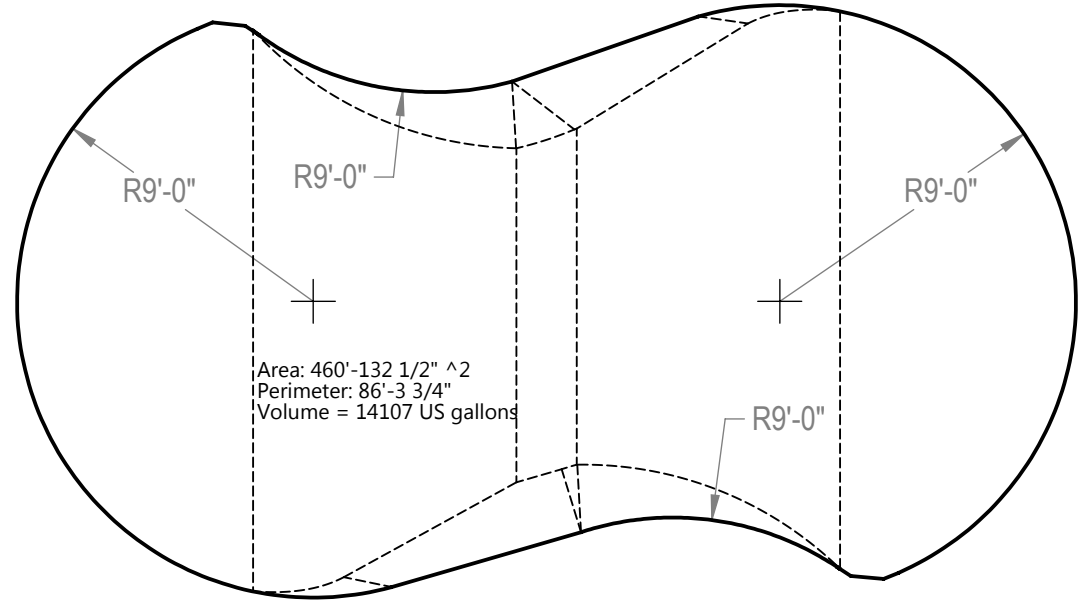
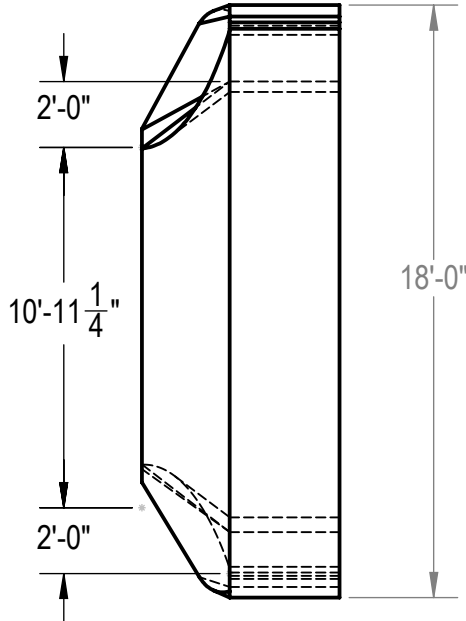

- NOTES:**
1. THESE ARE FINISHED DIMENSIONS READY FOR THE LINER.
  2. DIMENSIONS ARE FROM INSIDE POOL PANELS.
  3. THE IDEAL WATER LEVEL SHOULD BE TO THE MIDDLE OF THE SKIMMER OPENING(S).
- EXCAVATION NOTES:**
4. ROUGH EXCAVATION SHOULD BE 2' DEEPER IN EACH INSTANCE.
  5. SOIL TO HAVE MINIMUM BEARING CAPACITY OF 1500 PSF.
  6. LOCATE TOP OF POOL AT LEAST 6" ABOVE THE SURROUNDING LAND ELEVATION.
  7. SEE "OVER DIG DETAIL" FOR EXCAVATION AROUND POOL.
  8. FILL VOIDS UNDER BASE OF PANELS AND TAMP WELL.
  9. BACK FILL WITH NON-EXPANSIVE MATERIAL.
  10. ANSI / APSP / ICC-5 FOR RESIDENTIAL POOLS, 2003-2007 BOCA CODE SECTION 421.

**IMPORTANT NOTES:**

11. THIS DOCUMENT IS FOR ILLUSTRATIVE PURPOSES ONLY. THE DEALER OR CONTRACTOR WHO SELLS OR INSTALLS YOUR POOL IS AN INDEPENDENT CONTRACTOR AND IS NOT AN AGENT OF THE MANUFACTURER. THE CONSTRUCTION METHODS ILLUSTRATED HERE ARE SUGGESTIONS AND APPLY ONLY TO NORMAL GROUND CONDITIONS. THERE MAY BE ADDITIONAL PRECAUTIONS AND/OR METHODS OF CONSTRUCTION. PROPER INSTALLATION IS THE RESPONSIBILITY OF THE DEALER/BUILDER/CONTRACTOR.

ENGINEERING DRAWING NUMBER: <b>00004999</b>	WEIGHT:	<b>UNLESS OTHERWISE SPECIFIED</b> DIMENSIONS ARE IN INCHES TOLERANCES DECIMALS: X ± .1 XX ± .01 XXX ± .001 XXXX ± .0005  ANGULAR: X ± 0.5 THIRD ANGLE PROJECTION	DESIGNED BY:	CREATION DATE:	<b>HYDRA POOLS</b>
	lbs		RCOLBOCH	10/30/2013	
	VOLUME:			DETAILED BY:	DETAILED DATE:
	Inch <sup>3</sup>			JBOSSERDET	10/5/2012
COLOR:		LAST REVISED BY:	LAST REVISED DATE:	TITLE: <b>LAYOUT, 18' X 32'-2", BAHAMA, 6' DEEP, 100 SERIES</b>	
NA		jbosserdet	1/23/2015		
HEAT TREAT:		MATERIAL:		PART NUMBER:	<b>10901</b>
NA				SCALE:	1:128
FINISH:				SHEET:	2 OF 6
TEXTURE:				SIZE:	<b>A</b>
NA					

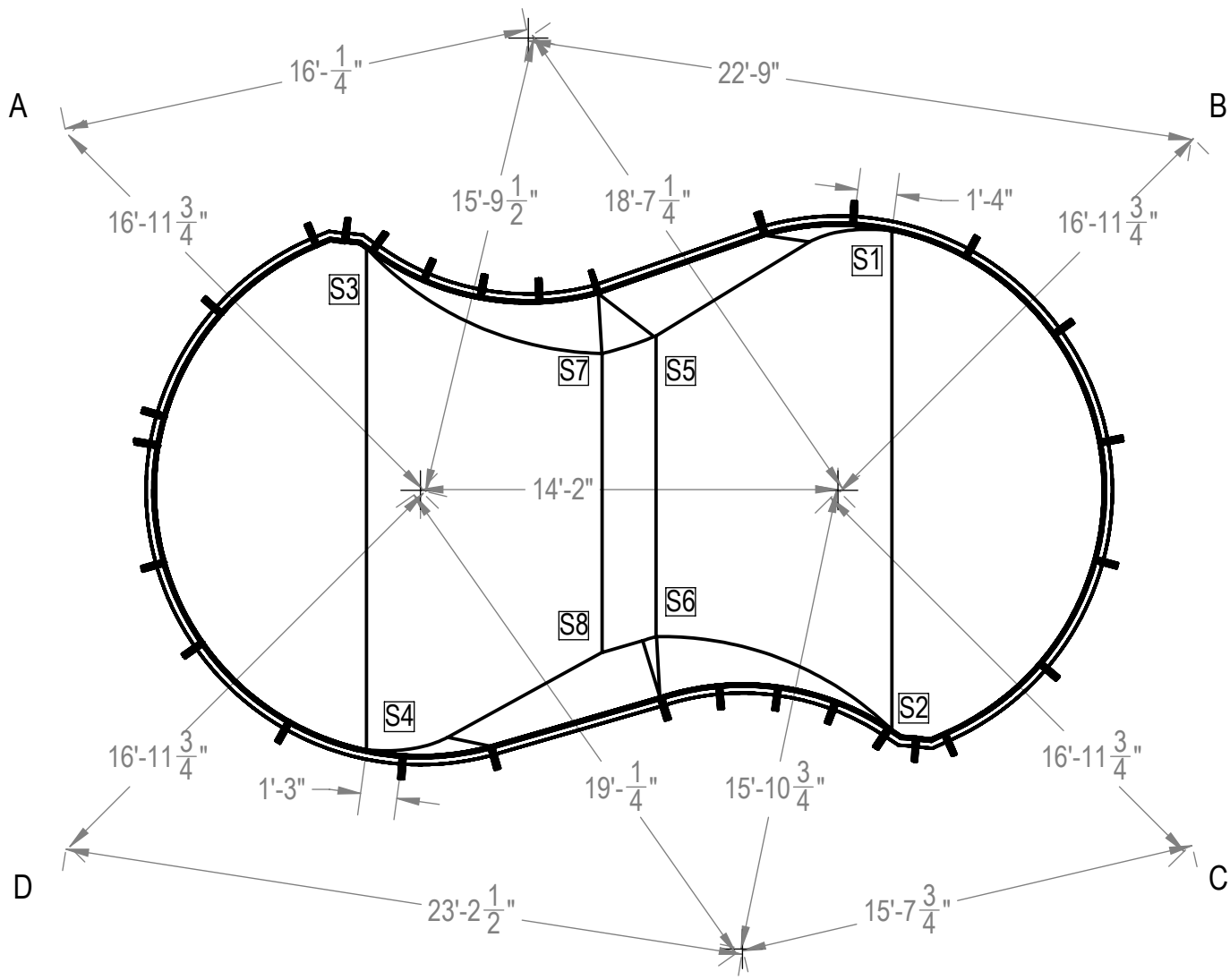

A-S1	28'-2 1/4"
B-S1	10'-8"
A-S2	34'-4 1/2"
B-S2	22'-6 1/2"
A-S3	11'- 3/4"
B-S3	28'-1 1/4"
A-S4	23'-3 1/4"
B-S4	34'-9 1/4"
A-S5	21'-1 1/4"
B-S5	19'-4 3/4"
A-S6	21'-1 1/4"
B-S6	19'-4 3/4"
A-S7	19'-5 3/4"
B-S7	21'-2 1/2"
A-S8	25'-2 1/4"
B-S8	26'-6 1/2"

ENGINEERING DRAWING NUMBER:  
**00004999**

WEIGHT:	
lbs	
VOLUME:	
Inch <sup>3</sup>	
COLOR:	
HEAT TREAT:	
NA	
FINISH:	
NA	
TEXTURE:	
NA	

**UNLESS OTHERWISE SPECIFIED**  
DIMENSIONS ARE IN INCHES  
TOLERANCES  
DECIMALS: X ± 0.1  
              XX ± 0.01  
              XXX ± 0.005  
              XXXX ± 0.0005  
ANGULAR: X ± 0.5  
THIRD ANGLE PROJECTION

DESIGNED BY:	RCOLBOCH
CREATION DATE:	10/30/2013
DETAILED BY:	JBOSSERDET
DETAILED DATE:	10/5/2012
LAST REVISED BY:	jbosserdet
LAST REVISED DATE:	1/23/2015
MATERIAL:	

<b>HYDRA POOLS</b>	
<b>LAYOUT, 18' X 32'-2", BAHAMA, 6' DEEP, 100 SERIES</b>	
PART NUMBER:	<b>10901</b>
SCALE:	1:128
SIZE:	<b>A</b>
SHEET:	3 OF 6

	A	B	C	D
1	10'-11 1/4"	36'-7"	37'-6 3/4"	13'-10 1/2"
2	10'-1"	36'-1 1/4"	37'-8 1/2"	14'-10 1/2"
3	8'-0"	33'-5 1/2"	37'-6"	18'-8 3/4"
4	9'-3 1/4"	29'-11"	35'-11 1/2"	21'-11 3/4"
5	10'-1 1/4"	28'-11 1/2"	35'-3"	22'-6"
6	11'- 3/4"	28'-1 1/4"	34'-3 3/4"	22'-7 1/4"
7	13'- 3/4"	26'-6 1/4"	32'-3 3/4"	22'-7 1/4"
8	15'- 3/4"	24'-9"	30'-5"	23'-2 3/4"
9	17'-0"	22'-10"	28'-9"	24'-4 1/2"
10	18'-9 3/4"	20'-10"	27'-5 1/2"	25'-11 1/2"
11	23'-11 1/4"	14'-10 1/4"	25'-2 3/4"	31'-5 1/4"
12	26'-10 1/4"	11'-10 1/2"	23'-11"	33'-11 1/4"
13	30'-9 1/4"	8'-8 1/2"	21'-3 3/4"	36'-5"
14	34'-1 3/4"	8'-2 1/2"	17'-10 3/4"	37'-8"
15	36'-6 1/2"	10'-10 1/4"	13'-11 3/4"	37'-7"
16	37'-8 1/4"	14'-8 3/4"	10'-2 1/2"	36'-2"
17	37'-6 1/4"	18'-7"	8'- 1/4"	33'-7"
18	36'- 1/4"	21'-11"	9'-2 1/4"	30'- 1/4"
19	35'-3 3/4"	22'-5"	10'- 1/4"	29'- 3/4"
20	34'-4 1/2"	22'-6 1/2"	10'-11 3/4"	28'-2 1/4"
21	32'-4 1/2"	22'-7 1/2"	13'-0"	26'-6 1/2"
22	30'-6 1/4"	23'-4"	15'- 1/4"	24'-8 3/4"
23	28'-11"	24'-6 3/4"	16'-11"	22'-9 1/4"
24	27'-8 1/4"	26'-2 1/2"	18'-8 1/2"	20'-8 3/4"
25	25'-2 1/4"	31'-6 1/4"	24'- 1/4"	14'-9 1/4"
26	23'-10 1/2"	34'- 1/4"	26'-11 1/4"	11'-9 1/2"
27	21'-2 3/4"	36'-5 3/4"	30'-10 3/4"	8'-7 3/4"
28	17'-9 1/4"	37'-8 1/4"	34'-2 3/4"	8'-3"
29	14'-10"	37'-8 1/2"	36'-1 1/2"	10'-1 1/2"

A-B	38'-2"
B-C	24'-0"
A-C	45'-1"

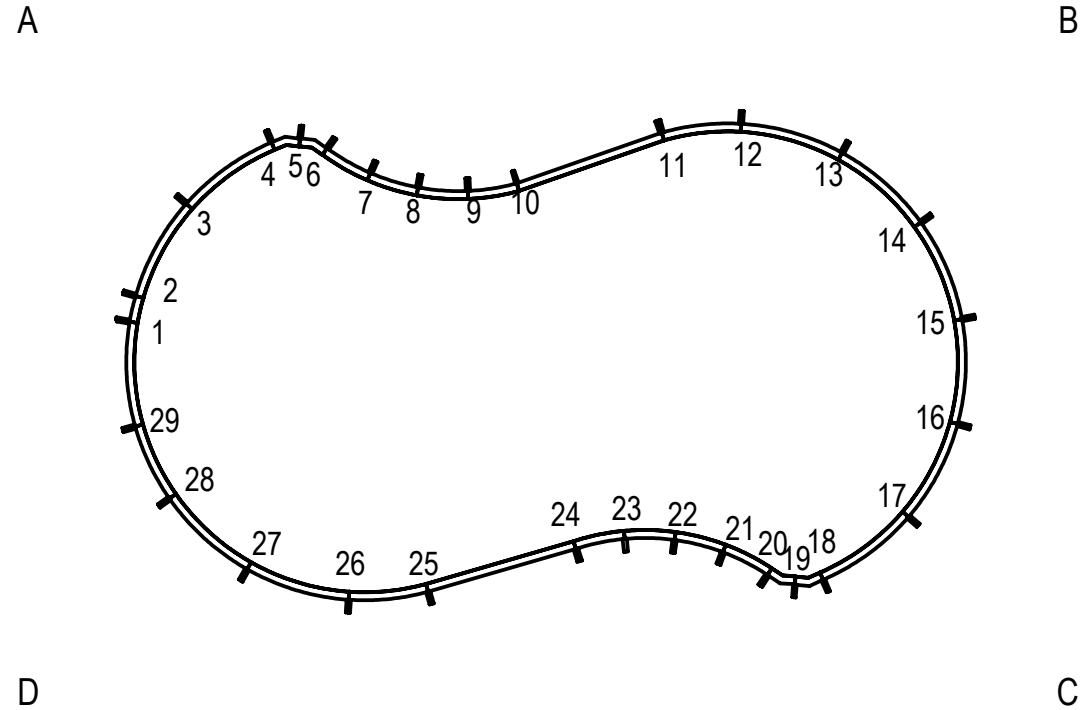

ENGINEERING DRAWING NUMBER:  
**00004999**

WEIGHT:	<b>UNLESS OTHERWISE SPECIFIED</b> DIMENSIONS ARE IN INCHES TOLERANCES DECIMALS: X ± 0.1 XX ± 0.01 XXX ± 0.005 XXXX ± 0.0005  ANGULAR: X ± 0.5 THIRD ANGLE PROJECTION
lbs	
VOLUME:	
Inch <sup>3</sup>	
COLOR:	
HEAT TREAT:	
NA	
FINISH:	
TEXTURE:	
NA	

DESIGNED BY:	RCOLBOCH
CREATION DATE:	10/30/2013
DETAILED BY:	JBOSSERDET
DETAILED DATE:	10/5/2012
LAST REVISED BY:	jbosserdet
LAST REVISED DATE:	1/23/2015
MATERIAL:	

<b>HYDRA POOLS</b>	
<b>LAYOUT, 18' X 32'-2", BAHAMA, 6' DEEP, 100 SERIES</b>	
PART NUMBER:	<b>10901</b>
SCALE:	1:128
SHEET:	4 OF 6
SIZE:	<b>A</b>

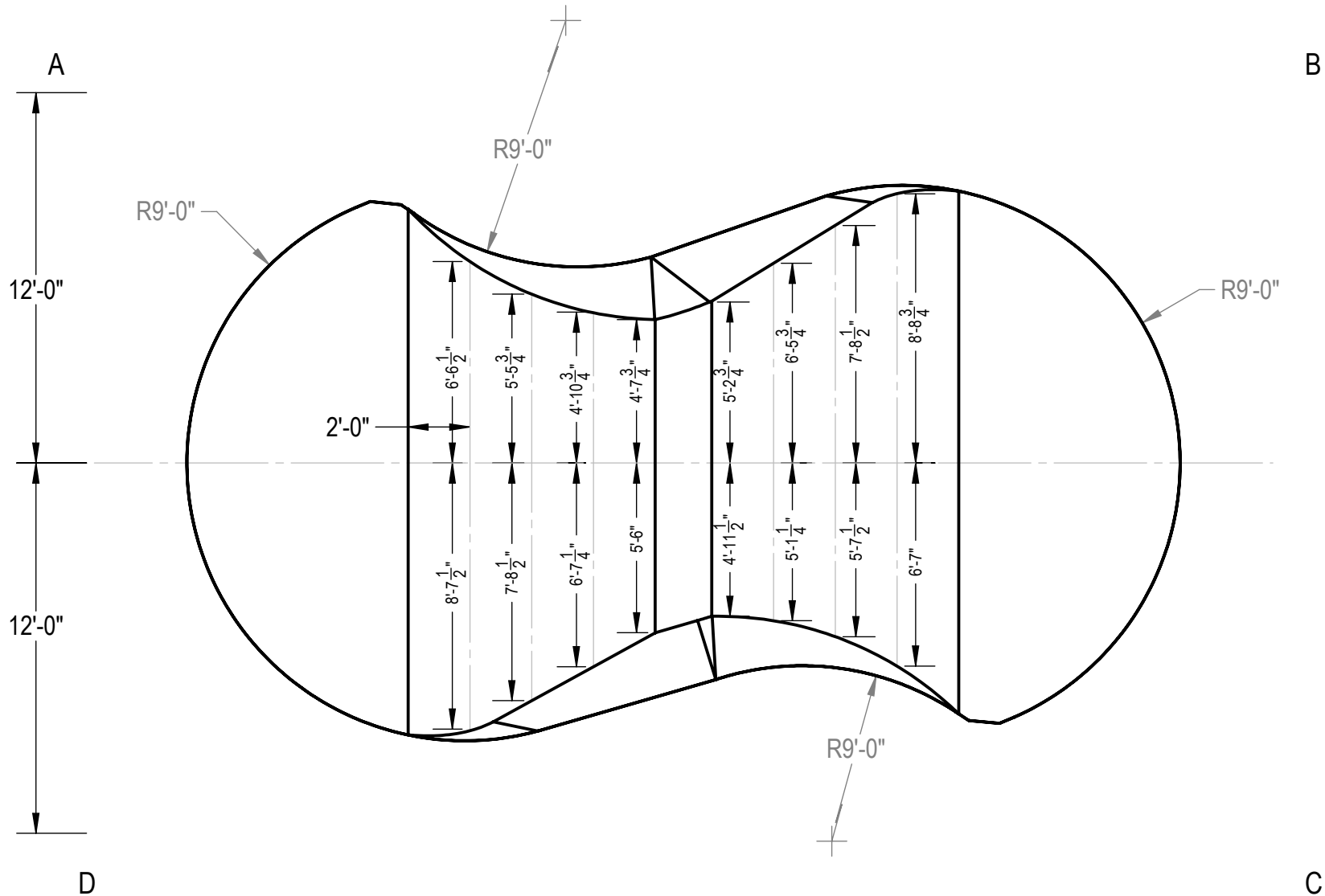

ENGINEERING DRAWING NUMBER: <b>00004999</b>	WEIGHT:	<b>UNLESS OTHERWISE SPECIFIED</b> DIMENSIONS ARE IN INCHES TOLERANCES DECIMALS: X ± 0.1 XX ± 0.01 XXX ± 0.005 XXXX ± 0.0005 ANGULAR: X ± 0.5 THIRD ANGLE PROJECTION	DESIGNED BY:	CREATION DATE:	<b>HYDRA POOLS</b>  <b>LAYOUT, 18' X 32'-2", BAHAMA, 6' DEEP,</b> <b>100 SERIES</b>		
	lbs		RCOLBOCH	10/30/2013			
	VOLUME:		DETAILED BY:	DETAILED DATE:			
	Inch <sup>3</sup>		JBOSSERDET	10/5/2012	PART NUMBER:	SCALE:	SIZE:
	COLOR:		LAST REVISED BY:	LAST REVISED DATE:	<b>10901</b>	1:128	<b>A</b>
	HEAT TREAT:		jbossdet	1/23/2015		SHEET:	
NA	MATERIAL:		5 OF 6				
FINISH:							
TEXTURE:							
NA							

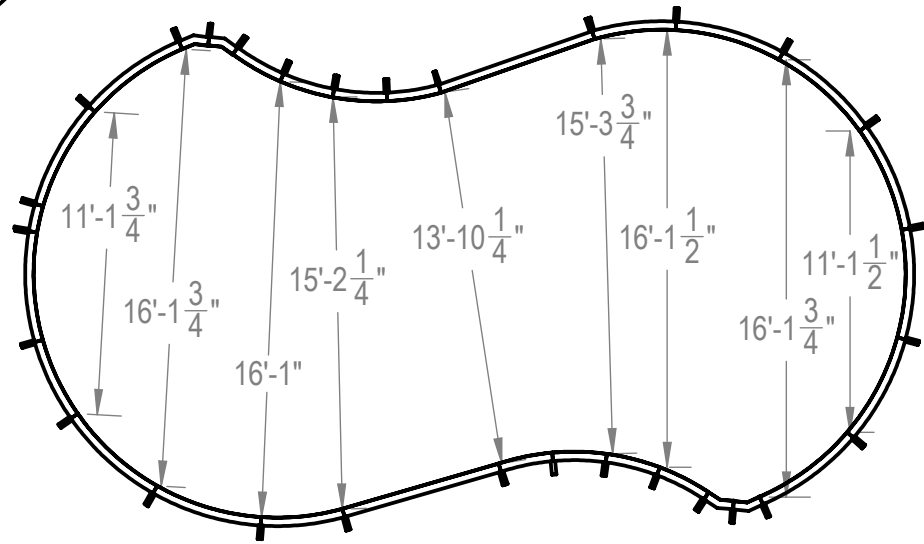
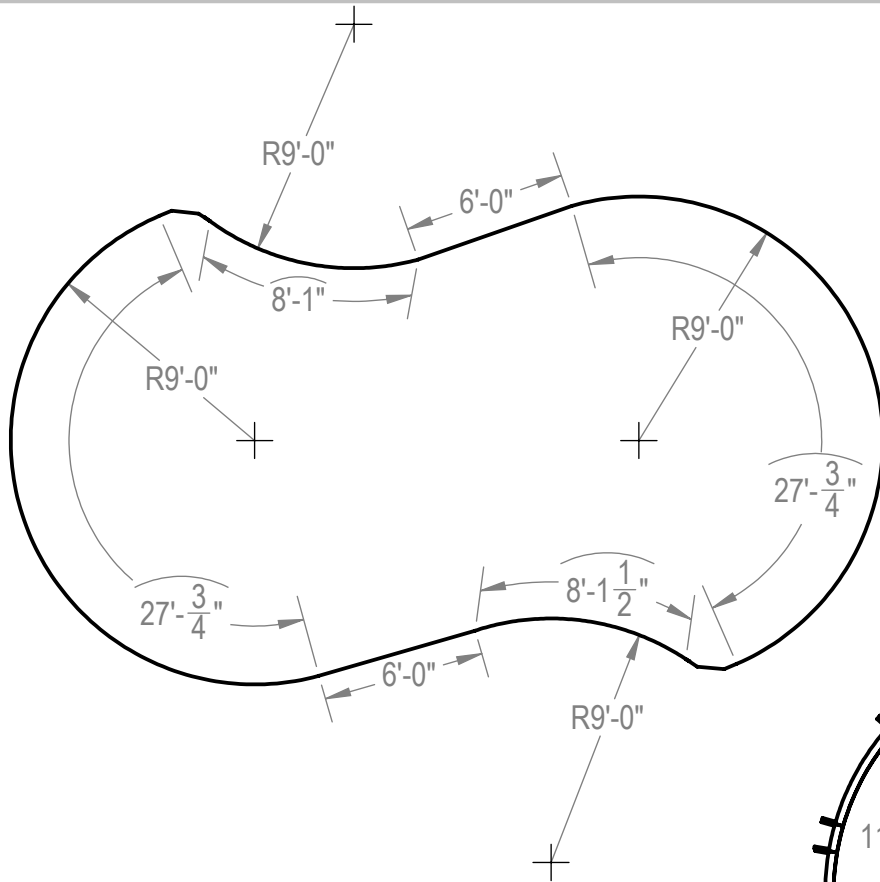

ENGINEERING DRAWING NUMBER: <b>00004999</b>	WEIGHT:	<b>UNLESS OTHERWISE SPECIFIED</b> DIMENSIONS ARE IN INCHES TOLERANCES DECIMALS: X ± 0.1 XX ± 0.01 XXX ± 0.005 XXXX ± 0.0005 ANGULAR: X ± 0.5 THIRD ANGLE PROJECTION	DESIGNED BY:	CREATION DATE:	<b>HYDRA POOLS</b>  <b>LAYOUT, 18' X 32'-2", BAHAMA, 6' DEEP,</b> <b>100 SERIES</b>
	lbs		RCOLBOCH	10/30/2013	
	VOLUME:		DETAILED BY:	DETAILED DATE:	
	Inch <sup>3</sup>		JBOSSERDET	10/5/2012	
	COLOR:		LAST REVISED BY:	LAST REVISED DATE:	
	NA		jbosserdet	1/23/2015	
HEAT TREAT:	MATERIAL:	PART NUMBER:	SCALE:	SIZE:	
NA		<b>10901</b>	1:128	<b>A</b>	
FINISH:			SHEET:		
NA			6 OF 6		
TEXTURE:					
NA					